

ITEM NO.	PART NUMBER	DESCRIPTION	QTY.
1	13363	SHAFT	1
2	04429	EXT. RETAINING RING	2
3	04289	INT. RETAINING RING	2
4	05133	SPACER	1
5	12314	TYPE 6A SEAL/SEAT ASSY	1
6	12344	FLANGE	1
7	12665	FLANGASKET	1
8	12666	WEAR PLATE	1
9	12231	O-RING	1
10	15383	HOUSING	1
11	15383	HOUSING	1
12	18996	SCREW 1/4-20 ROUND HD	1
13	18996	SCREW 1/4-20 ROUND HD	1
14	04432	CAM WASHER	1
15	04432	CAM WASHER	1
16	12770	WOODRUFF KEY	3
17	12657	RUBBER IMPELLER	3
18	12657	RUBBER IMPELLER	3
19	13285	1/4-20 HHCS	3
20	23382	TAG	1
21	23382	TAG	1
22	12211	FLANGE	1
23	12211	FLANGE	1
24	12211	BALL BEARING	2

NOTES:

1. APPLY BEAD OF PERMATEX AROUND CAM THREADED HOLE PRIOR TO ASSEMBLY ITEM 12
2. USE WATER ONLY WHEN INSTALLING TYPE 6A SEAL/SEAT ASSY ITEM 6
3. USE COOLANT TO AID IN INSTALLATION OF RUBBER IMPELLER ITEM 16
4. TORQUE 1/4-20 HHCS TO 5 - 8 FT.LBS. ITEM 18
5. PRESSURE TEST PUMP TO 20 - 30 PSI
6. PRINT G22 AND DATE CODE ON LABEL (21) AND ATTACH TO TAG (19) AS SHOWN

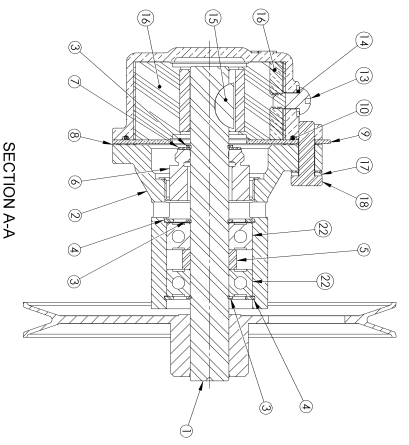

SECTION A-A

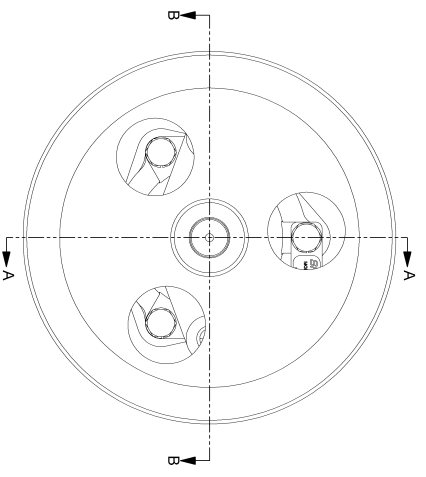

SECTION B-B

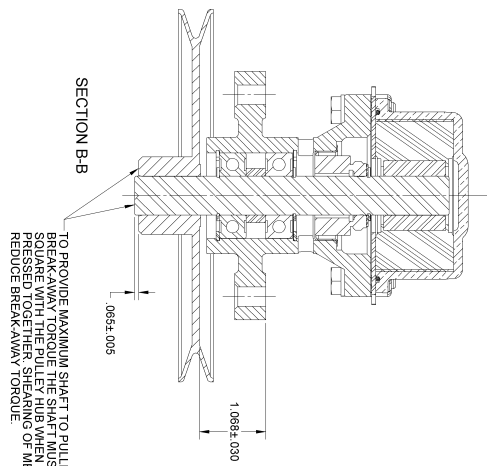

TO PROVIDE MAXIMUM SHAFT TO PULLEY BREAKAWAY TORQUE THE SHAFT MUST BE HELD SQUARE WITH THE PULLEY HUB WHEN THEY ARE PRESSED TOGETHER. SHEARING OF METAL WILL REDUCE BREAKAWAY TORQUE.

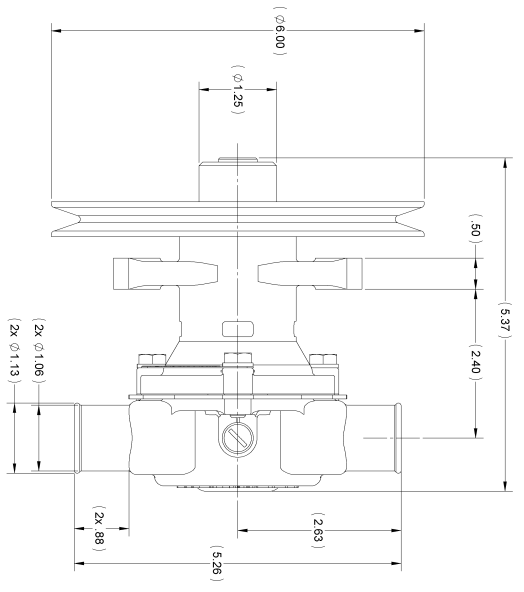
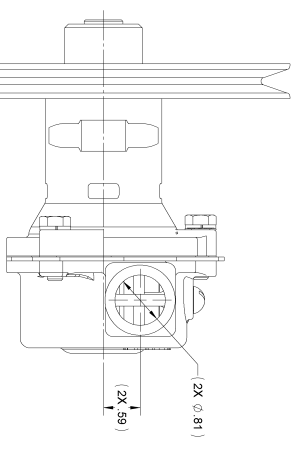
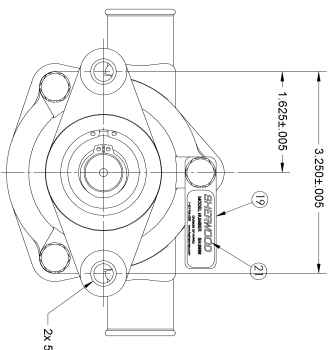

REV.	DATE	DESCRIPTION
4	05/27	REWORKED TO BE 2X 59 NC
3	05/27	REWORKED TO BE 2X 59 NC
2	05/27	REWORKED TO BE 2X 59 NC
1	05/27	REWORKED TO BE 2X 59 NC

SHERWOOD COMPANY
 207 Fern Avenue, New Bedford, MA 01521-1430
 508-548-2222

RUBBER IMPELLER PUMP

DATE: 11/03/1983
 DRAWN BY: RLM
 CHECKED BY: RLM
 SCALE: 1:1
 PART NUMBER: G22